

Project Name	
Project #	
Model #	
Type	

BHB-U063-BWHB- LED Series

FEATURES & SPECIFICATIONS

Intended Use: The BHB-BWHB series is an excellent choice for powerful and energy efficient retrofit. These lamps are made with positive cooling technology for advanced heat dissipation and to maximize the lifetime of the lamp. These lamps are made with high quality chips to provide a long lasting, lamp capable of meeting your lighting needs.

Installation: These Retrofits are ideal for High Bays.

Rating: IP20

Warranty: 5 years

Listings: UL

Beam Angle: 110°

CRI: >70

Fixture Body: Cold Forge polycarbonate lens

Dimensions:

○ ALL: 8 57/64 W x 8 61/64 H

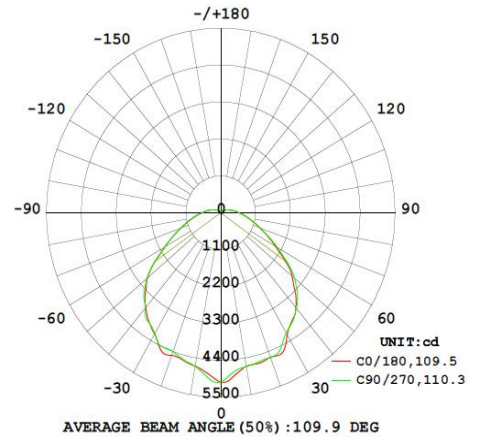
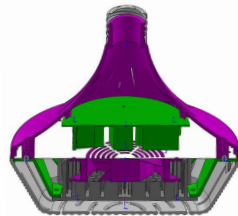
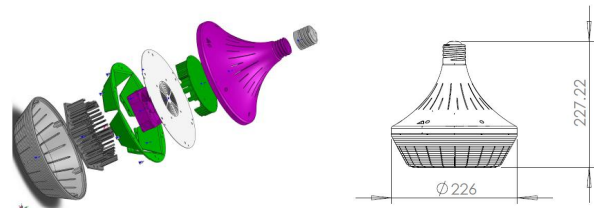

- ◆ UL Approved All for Enclosed Fixtures
- ◆ Ideal Application: 250W-600W Hi-Bay
- ◆ 150W: >20000lumens
- ◆ Failure Rate < 0.01%

ORDERING INFORMATION

EX: BHB-U063-BWHB-150-UNV-50K-GRY-E39

Series	Wattage (Lumens)	Input Voltage	Temperature	Finish	Lens	Mounting Hardware
1a. BHB-U063-WBHB	2a. 100 (100W; 15,000lm)	3a. 27V	4a. 27K (2700K)	5a. GR	6a. CL	7a. E39 (Mogul Base)
	2b. 120 (120W; 18,000lm)		4b. 30K (3000K)		6b. FR	
	2b. 150 (150W; 22,000lm)		4c. 40K (4000K)			
			4d. 50K (5000K)			
			4e. 57K (5700K)			

Notes:

If you do not see an option you would like please inquire directly and we will work to accommodate your needs.

3a. 100 - 277V input voltage 5a. Aluminum 6a. Lens Clear 6b. Lens Frosted

All of the products and specifications can change without prior notice

Please note this specification sheet is considered to be business promotional material and not used for product listing identification purposes

1834 NW 21st STREET MIAMI, FL 33142 | PHONE – 786.420.3600 | FAX – 786.420.3602 | SPECTRASOL-US.COM